

COLLEGE OF ENGINEERING PUNE
(An autonomous institute of Govt. of Maharashtra)

End Semester Examination

ENGINEERING GRAPHICS –II ME 102

Programme: F.Y.B.Tech

Year :2008-2009

Date :04-05-2009

Semester:II

Time :3 Hours (M)

Max Marks:40

Instructions : (1) All questions are compulsory
(2) Figures to the right indicate full marks
(3) Assume suitable data whenever necessary
(4) Retain all the construction lines and external constructions
(5) Dimensioning, line work and symbols carry due credits

Q No-1 Solve any two

- (a) Draw free hand sketches (two views) with proportions
- (1) Washer
 - (2) Split pin
 - (3) Castle nut
 - (4) Wing nut

Marks 10

- (b) A vertical cylinder of 60 mm diameter is penetrated by horizontal square prism, base 40 mm side, the axis of which is parallel to the V.P. and 10 mm away from the axis of the cylinder. A face of the prism makes an angle of 30 degrees with the H.P. Draw their projections showing curves of intersections.

Marks 10

- (c) Draw a semicircle with diameter AB of 160 mm and O as a centre of AB. Draw a regular pentagon of 40 mm side in it with O as one of its corners and the side opposite to the corner O, is parallel to the diameter AB.

This fig represents a development of a cone with a pentagon therein. Draw the projections of the cone and show how that pentagon will appear on the T.V. and the F.V. of the cone.

Marks 10

- (d) Using first angle projection method draw sectional front view (section along AA), top view, L.H. side view for the following object (Refer fig no 1)

Marks 10

Q.No-2 Draw the isometric view of the object shown in fig. (Refer fig No 2)

Marks 10

Q.No-3 Elevation and plan of the object are shown in fig. (refer fig No 3) Draw by using first angle method of projection; Sectional Elevation (section ~~BB~~ SS) left hand side view, plan

Marks 10

Fig. NO 01

Q. NO 01(d)

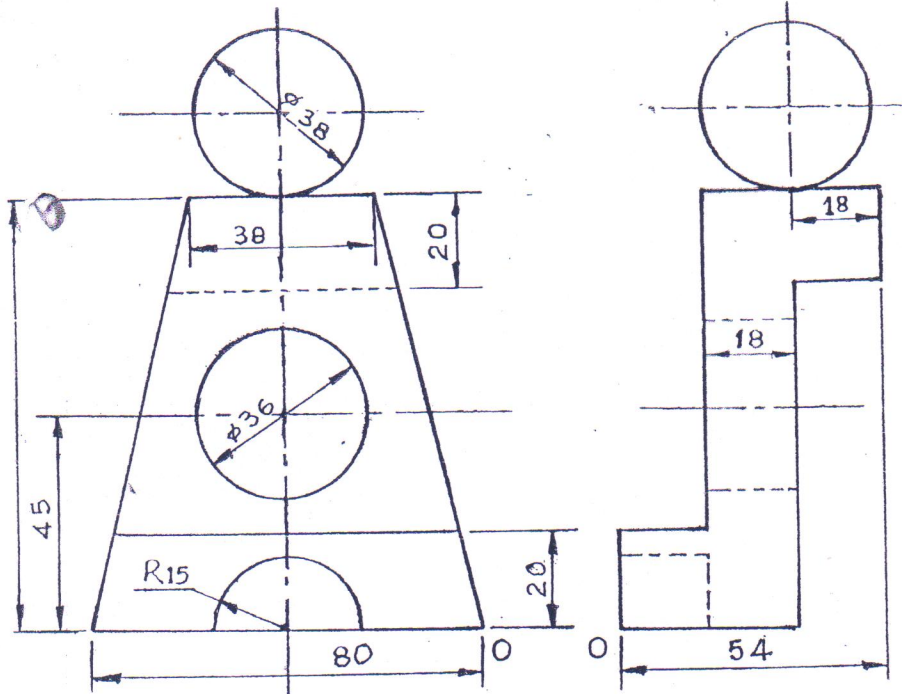
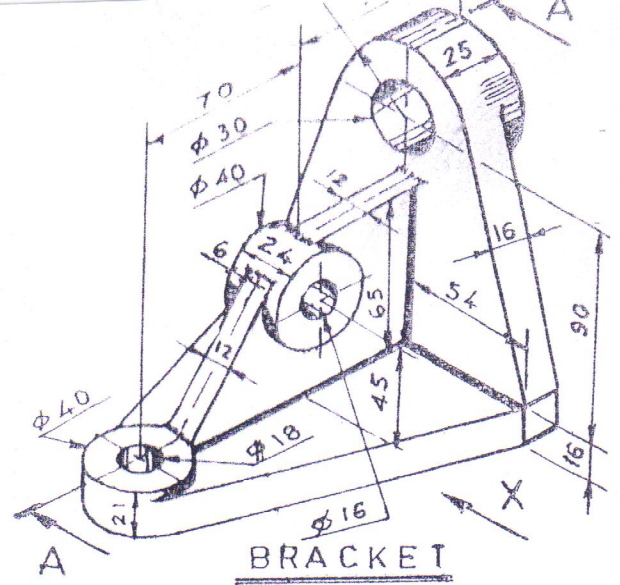

Fig. NO 02

Q. NO 02

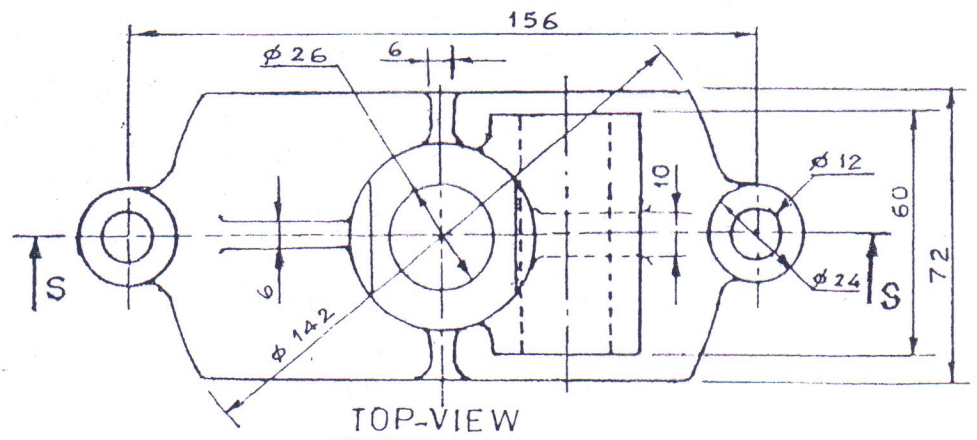

Fig. NO 03

Q. NO 03

